



CZECH
AVIATION
TRAINING
CENTRE

WELCOME

TO CZECH AVIATION TRAINING CENTRE



CATC, s.r.o., Hangár B, K Letišti 934/2, 161 00 Prague 6

Phone: +420 222 101 222

Email: info@catc.cz | Web: www.catc.cz



WELCOME

TO CZECH AVIATION TRAINING CENTRE

This information booklet will help you get answers to your questions about our training centre. It also provides useful information about hotels near Czech Aviation Training Centre, local transport, entertainment, access to the training centre, and other services.

It is not possible to list all the information, but in any case, you can count on us to help you with everything we can!

We hope you find the information in this booklet helpful. If you need our assistance, please contact us at +420 222 101 222 or by email at info@catc.cz.

Our business hours are:

6:30 to 18:30 Monday – Friday

8:30 to 16:30 Sat/Sun + public holidays: May 1st, 8th, July 5th, 6th, September 28th, October 28th, November 17th, December 25th, 26th

CATC is close on December 24th, 2023, and in January 1st2024.

We look forward to seeing you, your CATC!



Table of Contents:

INTRODUCTION	4
LOCATION OF SERVICES	5
Ground Floor	5
Second Floor	6
Third Floor	6
CLIENT SERVICES	7
ID Badges	7
Reception	7
Assistance	7
Training Schedule	7
Information	7
Photocopies/Faxes	7
Internet	7
Smoking	8
Coffee Break Area	8
Restaurant	8
Parking	8
Field Trip	8
HOW TO REACH US	9
Map of access to CATC	9
Hotels and map of accommodation arrangement by CATC	10
Public transport	10
TOURIST INFORMATION	11
Prague Tourism	11
Local Restaurants	11
Local Shop	11

Introduction

The Czech Aviation Training Centre /CATC/ has more than 80 years of experience in providing training services. It is based at Václav Havel Airport Prague and offers a wide range of professional pilot training, including wet and dry lease training services for A320, A330, B737 CL/NG, ATR 42/72, cabin crew training, maintenance training, IATA courses, dangerous goods training, aviation, and technical English courses.

CATC is recognized by key national and international authorities including the International Civil Aviation Organization /ICAO/ and the International Air Transport Association /IATA/ and holds several certificates that are renewed and updated in accordance with applicable aviation industry regulations and quality standards.

For more information on certificates, please visit: <https://www.catc.cz/en/certificates/>

CATC is in the airport security area. To enter CATC, you must present your passport at Gate 1, and you will be issued a visitor ID card/badge. If you arrive by car, you will also obtain a vehicle entry permit card, which must be always displayed on the dashboard when parking at CATC. Free parking is available in front of our building.



Location of services

Ground Floor

Reception/ Customer Care

Classrooms /122, 123, 124–139/

CBT Classrooms

B737CL FFS

ATR FTD

Briefing rooms ATR FTD Access to briefing rooms B737CL and A320 MTD

B737 CEET

ATR Door Trainer

Raft / slide A330

Offices of Engineers on Duty

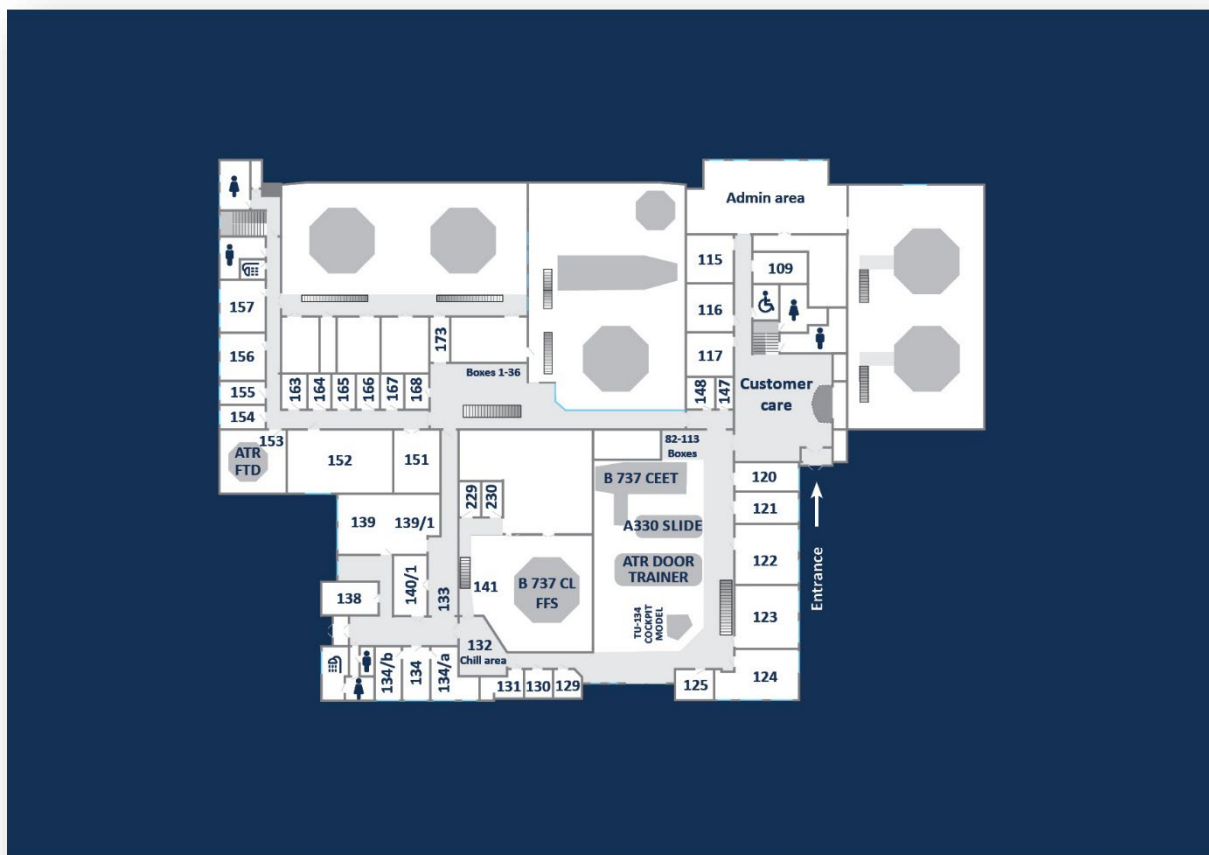

Second Floor

Classrooms /226, 241, 242, 243, 244, 245/

Briefing rooms and access to A320ceo FFS, A320neo/ceo FFS, B737NG FFS

Access to A320 CEET and A330 Door Trainer

Cockpit Procedure Trainer /B737, A320, L 410/

A320 MFTD

PC Flight Simulator

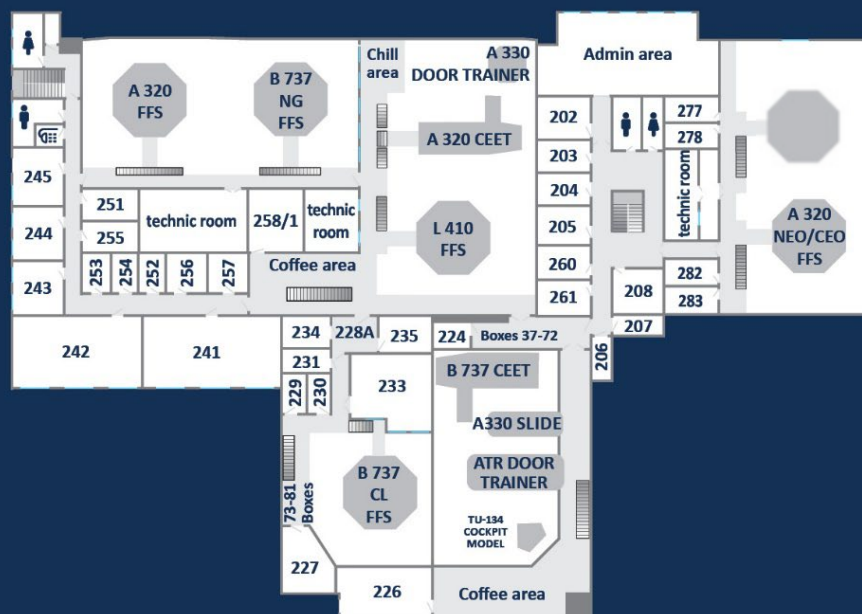

CLIENT SERVICES

ID Badges

ID badge must be always worn. It will be provided to you at the entrance Gate No. 1 / “Vrátnice 1”/ and it must be returned daily at the same place at the end of your training.

Reception

Our Training Facilities are open 24/7, except January 1st and December 24th.

Our main reception operates from Mon to Fri from 6:30 a.m. to 18:30 p.m., Sat to Sun + public holidays from 8:30 a.m. to 16:30 p.m.

To get access outside these hours please call phone number: +420 724 727 032.

Access to the building through the main entrance is available from 6:30 a.m. to 18:30 p.m. Mon-Fri, 8:30 a.m. to 4:30 p.m. Sat-Sun.

Assistance

If you have questions concerning your training course schedule or need some help, please do not hesitate to contact the Customer Care Coordinators at the reception desk, email: info@catc.cz, or phone: +420 222 101 222.

In case you need to see a doctor or a dentist, please contact Customer Care Coordinators at the reception.

In case of an injury or if immediate medical assistance is needed, first aid can be provided in the CATC building or at a medical centre /CATC does not pay for medical expenses/.

Useful telephone numbers:

SOS 112, Ambulance – 155, Fire – 150, Police - 158, City police - 156

Training Schedule

Our Training Scheduling Coordinators will do their best to make your schedule as convenient as possible. Any changes to your schedule will be offered by the Customer Care Coordinators.

Information

Simulators and class rosters can be found on the LCD information screen in the reception area.

Photocopies/Faxes

Printing, copying, and scanning equipment is available at the reception desk. Please ask our Customer Care Coordinators for assistance if you need to copy or scan your documents. Payment must be done in advance.

Internet

Wi-Fi service is available in all areas of the CATC building.

Smoking

There is a strict no-smoking policy throughout the CATC building. Smoking is only allowed in the designated area in front of the building.

Coffee Break Area

Coffee break facilities are located on the second floor. Our vending and tea/coffee machines are available 24 hours a day to provide our guests with drinks and refreshments/snacks. All vending machines accept Czech crown coins, or you may use your contactless payment card.

Restaurant

There are 2 restaurants near the CATC building directly on K Letišti Street. Both restaurants are within a 10-minute walk from the main gate 1.

FBA restaurant is open from 7:00 a.m. - 15:00 p.m. Monday to Friday /Closed: Saturday to Sunday/. Lunch in this restaurant costs about 100 - 180CZK and you can pay in cash or by card. It is also a suitable place to relax and enjoy a drink after a long day at the training centre:

<https://en.fba.cz/restaurant/>

The shopping centre "Šestka" offers several types of restaurants and various types of traditional fast food.

Parking

Parking is available in front of the CATC building. It is free of charge for our students and visitors.

Field Trip

If a part of your training takes place in SRA zone, be aware that:

ID badges must be worn and clearly visible.

The use of cameras is forbidden.

HOW TO REACH US

Václav Havel Airport Prague and our training centre, located 17 kilometres from the centre of Prague, are easily accessible by bus, taxi, or shuttle, or you can use public transport from Václav Havel Airport Prague or from the metro station called Nádraží Veleslavín.

The bus journey from the airport to the Czech Aviation Training Centre takes 8 minutes. You can reach our training centre by buses number 100, 119 or 191 /the stop is called "K Letišti"/. Bus tickets are available at the public transport counters in the arrival halls of both terminals /from 7:00 to 22:00/.

There are bus ticket machines at bus stops /cash required/.

The city centre is easily accessible from CATC. The metro station Nádraží Veleslavín can be reached by bus 119 in about 10 minutes. From here you can reach any other place in the centre of Prague within 10 minutes.



HOTELS

We can recommend several hotels in the vicinity of our training centre that offer excellent service at special CATC rates.

Our Customer Care Coordinators will be happy to arrange reservations for you, please contact them via mail: info@catc.cz

Map of the accommodation layout:

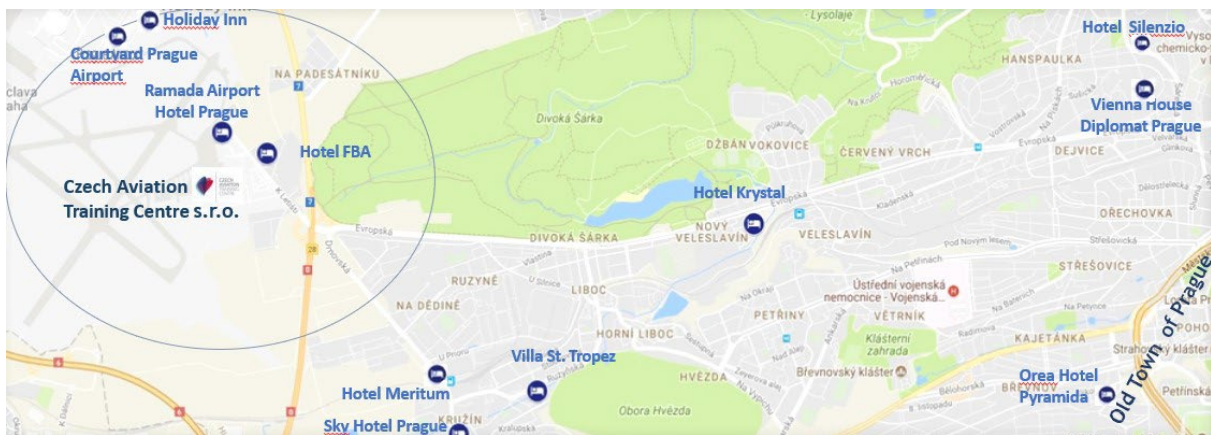

Public Transport

Click on the travel information page below to find out more about how to get around Prague.

<https://www.dpp.cz/en>

TOURIST INFORMATION

Prague Tourism

Prague is the capital and the largest city of the Czech Republic. It is one of the largest cities in Central Europe and has served as the capital of the historical region of Bohemia for centuries.

The city is famous for its unique medieval architecture, the Historic Centre of Prague is listed on the UNESCO World Heritage List. The following websites are good starting points to get more information about our country.

<https://www.visitczechrepublic.com/en-US>

www.wikitravel.org/en/Prague

www.getyourguide.com/Prague/Guided-Tour

www.lonelyplanet.com/czech-republic/prague

Local Restaurants

www.tasteofprague.com www.tripadvisor.com

www.grand-restaurant.cz/?lng=en

Local Shop

There is a shopping mall named “Šestka” reachable by walk from our training centre:

www.oc-sestka.cz/en/

The big shopping centre “Metropole Zličín” is accessible by bus No. 100 (1 stop):

www.metropole.cz/en/

POP - Premium Outlet Prague is 5 minutes from the airport, 30minutes from the city centre:

www.pop.cz/en